



VFC Series Flexible Vinyl Caps with Flat Pull-Tab for Easy Removal

Series VFC Caps feature a long flat tab centered at the top of the closure, which allows for easy removal of the cap.



MATERIAL: Vinyl
COLORS*: White, Black, Brown, Orange, Red, Green, Grey, Blue, Yellow – Call factory for colors in stock
AVAILABILITY: Consult Factory

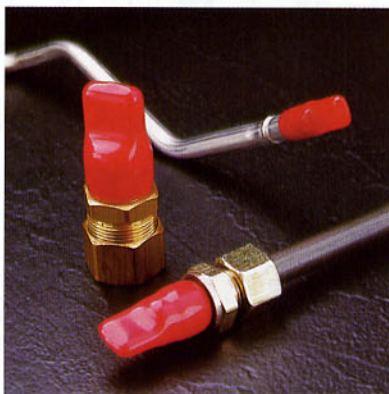
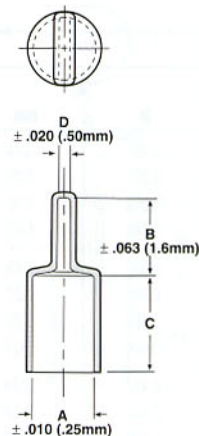

Note:

- VFC-180 through VFC-240 have a maximum length of 1.5".
- VFC-302 through VFC-1605 have various maximum lengths of up to 4".



VFC Series

Caplug No.	Dimensions								Packaging				Caplug No.
	A		B		C		D		Standard Carton		Mini Pak Quantity		
	in	mm	in	mm	in	mm	in	mm	Shipping Wt. (Approx.) lbs	kgs		No. of Pieces	
VFC-180-8	0.180	4.57	0.500	12.70	0.500	12.70	0.062	1.57	8	3.6	5000	1000	VFC-180-8
VFC-180-16	0.180	4.57	0.500	12.70	1.000	25.40	0.062	1.57	15	6.8	5000	1000	VFC-180-16
VFC-207-8	0.207	5.25	0.625	15.88	0.500	12.70	0.125	3.18	9	4.1	5000	1000	VFC-207-8
VFC-207-16	0.207	5.25	0.625	15.88	1.000	25.40	0.125	3.18	15	6.8	5000	1000	VFC-207-16
VFC-240-8	0.240	6.09	0.625	15.88	0.500	12.70	0.125	3.18	8	3.6	5000	1000	VFC-240-8
VFC-240-16	0.240	6.09	0.625	15.88	1.000	25.40	0.125	3.18	16	7.3	5000	1000	VFC-240-16
VFC-302-8	0.302	7.67	0.625	15.88	0.500	12.70	0.125	3.18	7	3.2	4000	800	VFC-302-8
VFC-302-16	0.302	7.67	0.625	15.88	1.000	25.40	0.125	3.18	20	9.1	4000	800	VFC-302-16
VFC-365-8	0.365	9.27	0.625	15.88	0.500	12.70	0.125	3.18	20	9.1	5000	1000	VFC-365-8
VFC-365-12	0.365	9.27	0.625	15.88	0.750	19.05	0.125	3.18	18	8.2	3000	600	VFC-365-12
VFC-365-16	0.365	9.27	0.625	15.88	1.000	25.40	0.125	3.18	16	7.3	2500	500	VFC-365-16
VFC-396-8	0.396	10.05	0.625	15.88	0.500	12.70	0.125	3.18	8	3.6	3000	600	VFC-396-8
VFC-396-16	0.396	10.05	0.625	15.88	1.000	25.40	0.125	3.18	19	8.6	3000	600	VFC-396-16
VFC-410-8	0.410	10.41	0.687	17.45	0.500	12.70	0.125	3.18	17	7.7	3000	600	VFC-410-8
VFC-410-16	0.410	10.41	0.687	17.45	1.000	25.40	0.125	3.18	16	7.3	2000	400	VFC-410-16
VFC-427-8	0.427	10.84	0.625	15.88	0.500	12.70	0.125	3.18	13	5.9	3000	600	VFC-427-8
VFC-427-16	0.427	10.84	0.625	15.88	1.000	25.40	0.125	3.18	18	8.2	2500	500	VFC-427-16
VFC-470-8	0.470	11.93	0.625	15.88	0.500	12.70	0.125	3.18	12	5.4	2000	400	VFC-470-8
VFC-470-16	0.470	11.93	0.625	15.88	1.000	25.40	0.125	3.18	18	8.2	2000	400	VFC-470-16
VFC-490-8	0.490	12.44	0.625	15.88	0.500	12.70	0.125	3.18	15	6.8	2500	500	VFC-490-8
VFC-490-16	0.490	12.44	0.625	15.88	1.000	25.40	0.125	3.18	13	5.9	1500	300	VFC-490-16
VFC-521-8	0.521	13.23	0.625	15.88	0.500	12.70	0.125	3.18	11	5.0	2000	400	VFC-521-8
VFC-521-16	0.521	13.23	0.625	15.88	1.000	25.40	0.125	3.18	14	6.4	1500	300	VFC-521-16
VFC-552-8	0.552	14.02	0.687	17.45	0.500	12.70	0.125	3.18	19	8.6	3000	600	VFC-552-8
VFC-552-12	0.552	14.02	0.687	17.45	0.750	19.05	0.125	3.18	15	6.8	2000	400	VFC-552-12
VFC-552-16	0.552	14.02	0.687	17.45	1.000	25.40	0.125	3.18	17	7.7	1500	300	VFC-552-16
VFC-590-8	0.590	14.98	0.625	15.88	0.500	12.70	0.125	3.18	8	3.6	1500	300	VFC-590-8
VFC-590-16	0.590	14.98	0.625	15.88	1.000	25.40	0.125	3.18	16	7.3	1500	300	VFC-590-16
VFC-615-8	0.615	15.62	0.687	17.45	0.500	12.70	0.125	3.18	9	4.1	2000	400	VFC-615-8
VFC-615-16	0.615	15.62	0.687	17.45	1.000	25.40	0.125	3.18	17	7.7	2000	400	VFC-615-16
VFC-677-8	0.677	17.19	0.687	17.45	0.500	12.70	0.125	3.18	9	4.1	1000	200	VFC-677-8
VFC-677-16	0.677	17.19	0.687	17.45	1.000	25.40	0.125	3.18	13	5.9	1000	200	VFC-677-16
VFC-735-8	0.735	18.66	0.812	20.63	0.500	12.70	0.187	4.75	8	3.6	1000	200	VFC-735-8
VFC-735-12	0.735	18.66	0.812	20.63	0.750	19.05	0.187	4.75	17	7.7	1250	250	VFC-735-12
VFC-735-16	0.735	18.66	0.812	20.63	1.000	25.40	0.187	4.75	16	7.3	1000	200	VFC-735-16
VFC-797-8	0.797	20.24	0.812	20.63	0.500	12.70	0.187	4.75	8	3.6	900	180	VFC-797-8
VFC-797-16	0.797	20.24	0.812	20.63	1.000	25.40	0.187	4.75	17	7.7	900	180	VFC-797-16
VFC-865-8	0.865	21.97	0.843	21.41	0.500	12.70	0.187	4.75	14	6.4	1000	200	VFC-865-8
VFC-865-16	0.865	21.97	0.843	21.41	1.000	25.40	0.187	4.75	15	6.8	800	160	VFC-865-16
VFC-990-8	0.990	25.14	0.875	22.23	0.500	12.70	0.187	4.75	5	2.3	600	120	VFC-990-8
VFC-990-16	0.990	25.14	0.875	22.23	1.000	25.40	0.187	4.75	9	4.1	600	120	VFC-990-16
VFC-1230-16	1.230	31.24	1.125	28.58	1.000	25.40	0.187	4.75	11	5.0	500	100	VFC-1230-16
VFC-1230-24	1.230	31.24	1.125	28.58	1.500	38.10	0.187	4.75	18	8.2	500	100	VFC-1230-24
VFC-1605-16	1.605	40.76	1.250	31.75	1.000	25.40	0.250	6.35	16	7.3	400	80	VFC-1605-16
VFC-1605-24	1.605	40.76	1.250	31.75	1.500	38.10	0.250	6.35	17	7.7	400	80	VFC-1605-24



VVC Vent-A-Cap™ Series Vinyl Vented Caps

The Vent-A-Cap Series consists of several styles of caps used to protect the ends of tubing connectors and instrument tips.

Vented for air release and easy removal, the vented caps are also useful in the masking industry. Venting for airflow assures that the cap won't pop off during extreme heat. Caps used in the medical

industry allow for airflow during ETO gas sterilization. Series 20, Series 22 and Series 26 are tapered to fit multiple sizes for a variety of tubing and instruments. Series 29 is offered in a straight style.



MATERIAL: Vinyl
COLORS*: White, Black, Brown, Orange, Red, Green, Grey, Blue, Yellow – Call factory for colors in stock

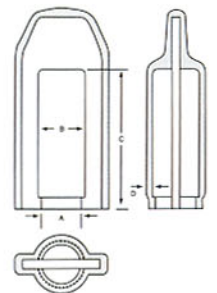
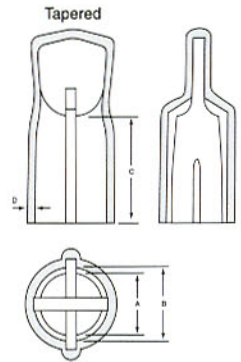
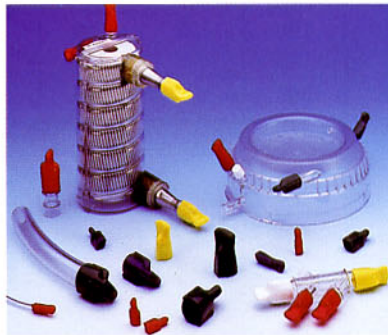
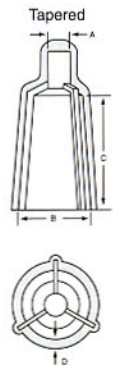
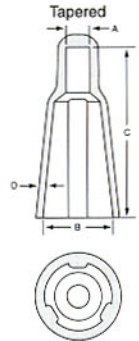



VVC Vent-A-Cap™ Series

20 Series

Caplug No.	Dimensions										Packaging				Caplug No.
	To Fit Tube Size	A		B		C		D		Standard Carton		Mini Pak Quantity			
		in	mm	in	mm	in	mm	in	mm	Shipping Wt. (Approx.) lbs	kgs		No. of Pieces		
VVC-2071	1/4 x 1/16	0.200	5.08	0.425	10.80	1.600	40.64	0.055	1.40	24	10.9	5000	1000	VVC-2071	
VVC-2072	1/4 x 3/32	0.250	6.35	0.500	12.70	1.600	40.64	0.055	1.40	28	12.7	5000	1000	VVC-2072	
VVC-2073	3/8 x 1/16	0.250	6.35	0.525	13.34	1.600	40.64	0.055	1.40	33	15.0	5000	1000	VVC-2073	
VVC-2074	3/8 x 3/32	0.250	6.35	0.610	15.49	1.600	40.64	0.055	1.40	38	17.2	5000	1000	VVC-2074	
VVC-2075	1/2 x 1/16	0.250	6.35	0.650	16.51	1.600	40.64	0.055	1.40	40	18.1	5000	1000	VVC-2075	
VVC-2076	1/2 x 3/32	0.275	6.99	0.735	18.67	1.600	40.64	0.055	1.40	31	14.1	4000	800	VVC-2076	

22 Series

Caplug No.	Dimensions										Packaging				Caplug No.
	To Fit Tube Size	A		B		C		D		Standard Carton		Mini Pak Quantity			
		in	mm	in	mm	in	mm	in	mm	Shipping Wt. (Approx.) lbs	kgs		No. of Pieces		
VVC-2220	1/8 x 1/32	0.080	2.03	0.190	4.83	0.430	10.92	0.045	1.14	11	5.0	10000	1000	VVC-2220	
VVC-2221	1/8 x 1/16	0.156	3.96	0.310	7.87	1.075	27.31	0.055	1.40	17	7.7	5000	1000	VVC-2221	
VVC-2222	3/16 x 1/16	0.156	3.96	0.340	8.64	1.075	27.31	0.055	1.40	26	11.8	5000	1000	VVC-2222	
VVC-2223	1/4 x 1/16	0.200	5.08	0.400	10.16	1.075	27.31	0.055	1.40	32	14.5	5000	1000	VVC-2223	
VVC-2224	1/4 x 1/32	0.240	6.10	0.450	11.43	1.075	27.31	0.055	1.40	35	15.9	5000	1000	VVC-2224	
VVC-2225	3/8 x 1/16	0.250	6.35	0.510	12.95	1.075	27.31	0.055	1.40	33	15.0	5000	1000	VVC-2225	
VVC-2226	3/8 x 3/32	0.250	6.35	0.590	14.99	1.175	29.85	0.055	1.40	37	16.8	4000	800	VVC-2226	
VVC-2227	1/2 x 1/16	0.312	7.92	0.650	16.51	1.175	29.85	0.060	1.52	39	17.7	4000	800	VVC-2227	
VVC-2228	1/2 x 1/8	0.312	7.92	0.700	17.78	1.175	29.85	0.060	1.52	29	13.2	3000	600	VVC-2228	
VVC-2229	1/2 x 3/32	0.312	7.92	0.750	19.05	1.175	29.85	0.060	1.52	31	14.1	3000	600	VVC-2229	
VVC-2230	5/8 x 3/32	0.330	8.38	0.880	23.35	1.175	29.85	0.065	1.65	39	17.7	3000	600	VVC-2230	

26 Series

Caplug No.	Dimensions										Packaging				Caplug No.
	To Fit Tube Size	A		B		C		D		Standard Carton		Mini Pak Quantity			
		in	mm	in	mm	in	mm	in	mm	Shipping Wt. (Approx.) lbs	kgs		No. of Pieces		
VVC-2600	1/8 x 1/32	0.160	4.06	0.210	5.33	0.400	10.16	0.045	1.14	22	10.0	10000	1000	VVC-2600	
VVC-2601	1/8 x 1/16	0.190	4.83	0.275	6.99	0.650	16.25	0.055	1.40	33	15.0	10000	1000	VVC-2601	
VVC-2602	3/16 x 1/16	0.240	6.10	0.340	8.64	0.650	16.25	0.055	1.40	32	14.5	8000	1000	VVC-2602	
VVC-2603	1/4 x 1/16	0.325	8.26	0.400	10.16	0.750	19.05	0.055	1.40	26	11.8	5000	1000	VVC-2603	
VVC-2604	1/4 x 3/32	0.375	9.53	0.470	11.94	0.750	19.05	0.055	1.40	26	11.8	5000	1000	VVC-2604	
VVC-2605	3/8 x 1/16	0.440	11.18	0.525	13.34	0.750	19.05	0.055	1.40	30	13.6	5000	1000	VVC-2605	
VVC-2606	3/8 x 3/32	0.475	12.07	0.585	14.86	0.750	19.05	0.055	1.40	35	15.9	5000	1000	VVC-2606	
VVC-2607	1/2 x 1/16	0.550	13.97	0.650	16.51	0.800	20.32	0.060	1.52	33	15.0	3000	600	VVC-2607	
VVC-2608	1/2 x 3/32	0.630	16.00	0.710	18.03	0.800	20.32	0.060	1.52	32	14.5	3000	600	VVC-2608	
VVC-2609	1/2 x 1/8	0.650	16.51	0.775	19.69	0.800	20.32	0.060	1.52	34	15.4	3000	600	VVC-2609	
VVC-2610	5/8 x 3/32	0.775	19.69	0.840	21.34	0.800	20.32	0.060	1.52	37	16.8	3000	600	VVC-2610	

29 Series

Caplug No.	Dimensions										Packaging				Caplug No.
	To Fit Tube Size	A		B		C		D		Standard Carton		Mini Pak Quantity			
		in	mm	in	mm	in	mm	in	mm	Shipping Wt. (Approx.) lbs	kgs		No. of Pieces		
VVC-2920	1/8 x 1/16	0.230	5.84	0.281	7.14	0.700	17.78	0.045	1.14	35	15.9	10000	1000	VVC-2920	
VVC-2922	3/16 x 1/16	0.292	7.45	0.343	8.71	0.650	16.51	0.050	1.27	39	17.7	10000	1000	VVC-2922	
VVC-2924	1/4 x 1/16	0.355	9.02	0.415	10.54	0.750	19.05	0.055	1.40	28	12.7	5000	1000	VVC-2924	
VVC-2926	1/4 x 3/32	0.417	10.59	0.477	12.12	0.750	19.05	0.055	1.40	41	18.6	5000	1000	VVC-2926	
VVC-2928	3/8 x 1/16	0.480	12.19	0.540	13.72	0.850	21.59	0.060	1.52	41	18.6	5000	1000	VVC-2928	
VVC-2930	3/8 x 3/32	0.542	13.77	0.602	15.29	0.900	22.86	0.060	1.52	44	20.0	5000	1000	VVC-2930	
VVC-2932	1/2 x 3/32	0.667	16.94	0.737	18.72	0.875	22.23	0.060	1.52	35	15.9	3000	600	VVC-2932	
VVC-2934	5/8 x 3/32	0.792	20.12	0.875	22.23	0.875	22.23	0.065	1.65	37	16.8	3000	600	VVC-2934	



CAPS Polaris Vinyl

VCF Series Vinyl Caps with Flanges

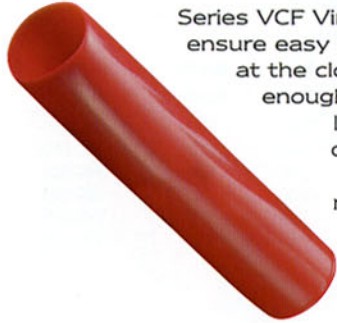

Series VCF Vinyl Caps with Flanges ensure easy removal with a flange at the closed end that is small enough not to interfere, but large enough to grasp during removal. These caps are available in most of the Series VC sizes, and come in 9 standard colors.



MATERIAL: Vinyl
COLORS*: White, Black, Brown, Orange, Red, Green, Grey, Blue, Yellow – Call for colors in stock

(Not available in high temp material)

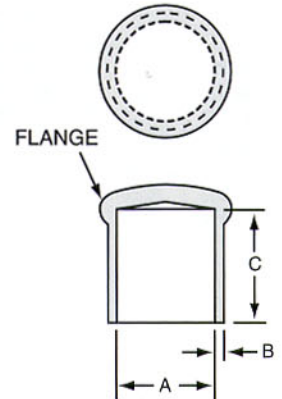

Note:

- VCF-125 has a maximum length of 1.5".
- VCF-140 through VCF-250 have a maximum length of 2".
- VCF-281 through VCF-3125 have various maximum lengths of up to 8". Call factory for details.

Caplug No.	Dimensions						Packaging				Caplug No.
	A		B		C		Standard Carton		Mini Pak Quantity		
	in	mm	in	mm	in	mm	Shipping Wt.(Approx.) lbs	kgs		No. of Pieces	
VCF-125-8	0.125	3.17	0.035	0.89	.500	12.7	3	1.4	5000	1000	VCF-125-8
VCF-125-16	0.125	3.17	0.035	0.89	1.000	25.4	4	1.8	5000	1000	VCF-125-16
VCF-140-8	0.140	3.55	0.040	1.02	.500	12.7	2	1.0	5000	1000	VCF-140-8
VCF-140-16	0.140	3.55	0.040	1.02	1.000	25.4	5	2.3	5000	1000	VCF-140-16
VCF-156-8	0.156	3.96	0.040	1.02	.500	12.7	2	1.0	5000	1000	VCF-156-8
VCF-156-16	0.156	3.96	0.040	1.02	1.000	25.4	6	2.7	5000	1000	VCF-156-16
VCF-172-8	0.172	4.36	0.040	1.02	.500	12.7	3	1.4	5000	1000	VCF-172-8
VCF-172-16	0.172	4.36	0.040	1.02	1.000	25.4	6	2.7	5000	1000	VCF-172-16
VCF-187-8	0.187	4.74	0.040	1.02	.500	12.7	3	1.4	5000	1000	VCF-187-8
VCF-187-16	0.187	4.74	0.040	1.02	1.000	25.4	6	2.7	5000	1000	VCF-187-16
VCF-187-24	0.187	4.74	0.040	1.02	1.500	38.1	16	7.3	4000	800	VCF-187-24
VCF-203-8	0.203	5.15	0.045	1.14	.500	12.7	4	1.8	5000	1000	VCF-203-8
VCF-203-16	0.203	5.15	0.045	1.14	1.000	25.4	8	3.6	5000	1000	VCF-203-16
VCF-218-8	0.218	5.53	0.045	1.14	.500	12.7	5	2.3	5000	1000	VCF-218-8
VCF-218-16	0.218	5.53	0.045	1.14	1.000	25.4	9	4.1	5000	1000	VCF-218-16
VCF-234-8	0.234	5.94	0.045	1.14	.500	12.7	5	2.3	5000	1000	VCF-234-8
VCF-234-16	0.234	5.94	0.045	1.14	1.000	25.4	10	4.5	5000	1000	VCF-234-16
VCF-250-8	0.250	6.35	0.050	1.27	.500	12.7	6	2.7	5000	1000	VCF-250-8
VCF-250-16	0.250	6.35	0.050	1.27	1.000	25.4	15	6.8	5000	1000	VCF-250-16
VCF-281-8	0.281	7.13	0.050	1.27	.500	12.7	6	2.7	5000	1000	VCF-281-8
VCF-281-16	0.281	7.13	0.050	1.27	1.000	25.4	15	6.8	5000	1000	VCF-281-16
VCF-281-24	0.281	7.13	0.050	1.27	1.500	38.1	9	4.1	2500	500	VCF-281-24
VCF-312-8	0.312	7.92	0.055	1.40	.500	12.7	7	3.2	5000	1000	VCF-312-8
VCF-312-16	0.312	7.92	0.055	1.40	1.000	25.4	21	9.5	5000	1000	VCF-312-16
VCF-312-24	0.312	7.92	0.055	1.40	1.500	38.1	24	10.9	5000	1000	VCF-312-24
VCF-343-8	0.343	8.71	0.055	1.40	.500	12.7	9	4.1	5000	1000	VCF-343-8
VCF-343-16	0.343	8.71	0.055	1.40	1.000	25.4	8	3.6	2500	500	VCF-343-16
VCF-375-8	0.375	9.52	0.060	1.52	.500	12.7	9	4.1	5000	1000	VCF-375-8
VCF-375-16	0.375	9.52	0.060	1.52	1.000	25.4	13	5.9	2500	500	VCF-375-16
VCF-406-8	0.406	10.31	0.060	1.52	.500	12.7	10	4.5	5000	1000	VCF-406-8
VCF-406-16	0.406	10.31	0.060	1.52	1.000	25.4	9	4.1	2500	500	VCF-406-16
VCF-437-8	0.437	11.09	0.060	1.52	.500	12.7	11	5.0	5000	1000	VCF-437-8